

# 661-0374-XXX-D-C SPECIFICATIONS

-XXX	COLOR	SPECTRUM	VIEWING ANGLE	-D	-C
-BL	BLUE	470NM	30 °	DIFFUSED	COLLIMATED
-IR	INFRARED	875NM	30 °		
-NIR	NEAR INFRARED	735NM	30 °		
-RD	RED	630NM	30 °		
-WHT	WHITE	WHITE	30 °		

POWER INPUT VOLTAGE: 24 VDC
POWER INPUT CURRENT: 1.7 AMPS Strobe 0.5 AMPS Static
TRIGGER INPUT VOLTAGE: 0-26 VDC
TRIGGER TURN-ON VOLTAGE: >3.3 VDC
TRIGGER TURN-OFF VOLTAGE: <1.5 VDC
TRIGGER INPUT PULSE WIDTH: 25-500 usec
MAXIMUM TRIGGER RATE: 0-60 HZ, (3% duty cycle)

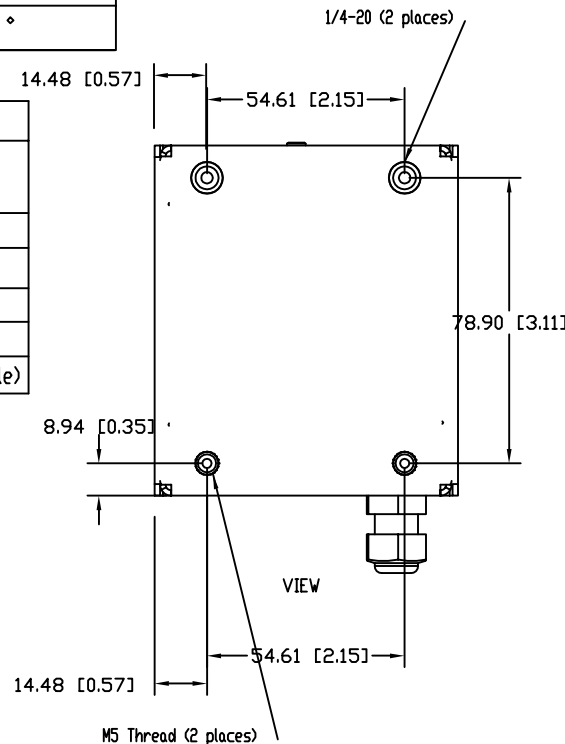

Strobe Mode Wiring Diagram

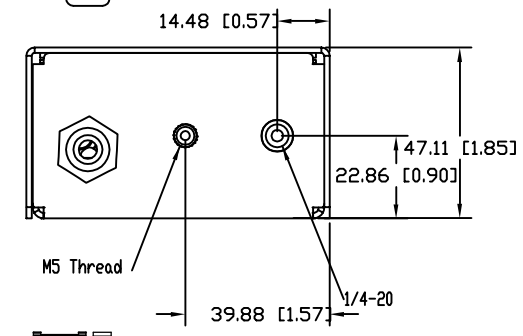
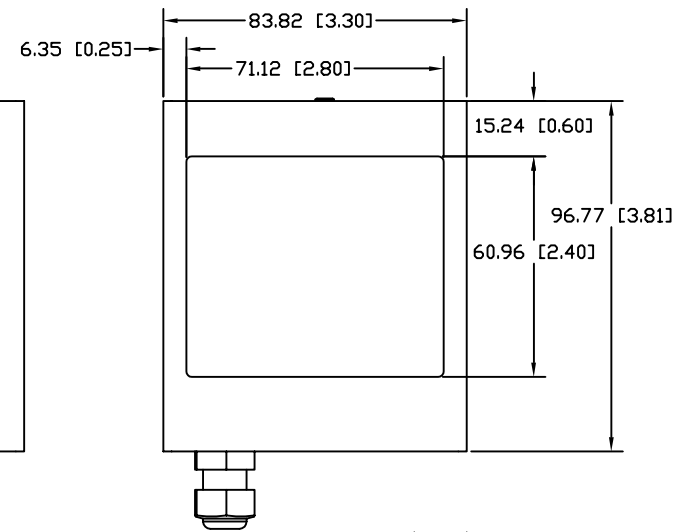
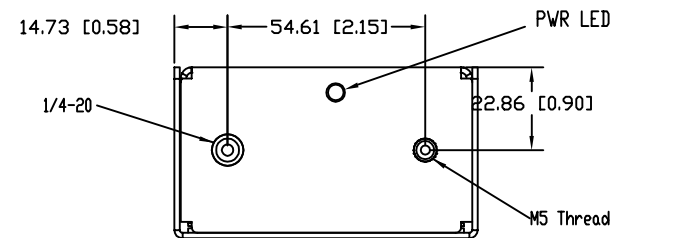
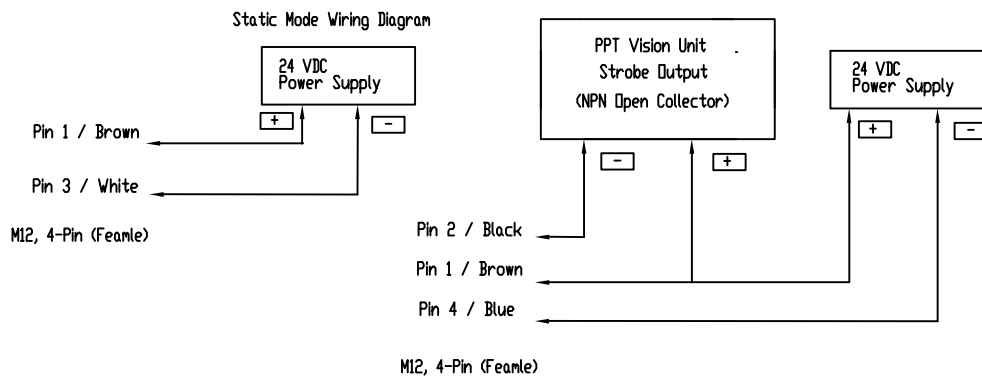

Standard M12, 4 PIN (MALE)

PIN	SIGNAL	COLOR
1	+24 VDC	Brown
2	Strobe Trigger +	Black
3	Static 0 VDC	White
4	Strobe 0 VDC	Blue

**PPT VISION**

DWG. NO. 844-2021 REV A

DATE: 3/20/07 SHEET 1 OF 1