

REV	NO.	ECO	CHANGE	BY	DATE	SHEET
A		1154	Release for production	JGM	4/10/02	
B		1358	Replaced strain relief	JGM	5/7/03	1 & 3
C		1389	Rvsd notes & table	JGM	7/10/03	1 & 2

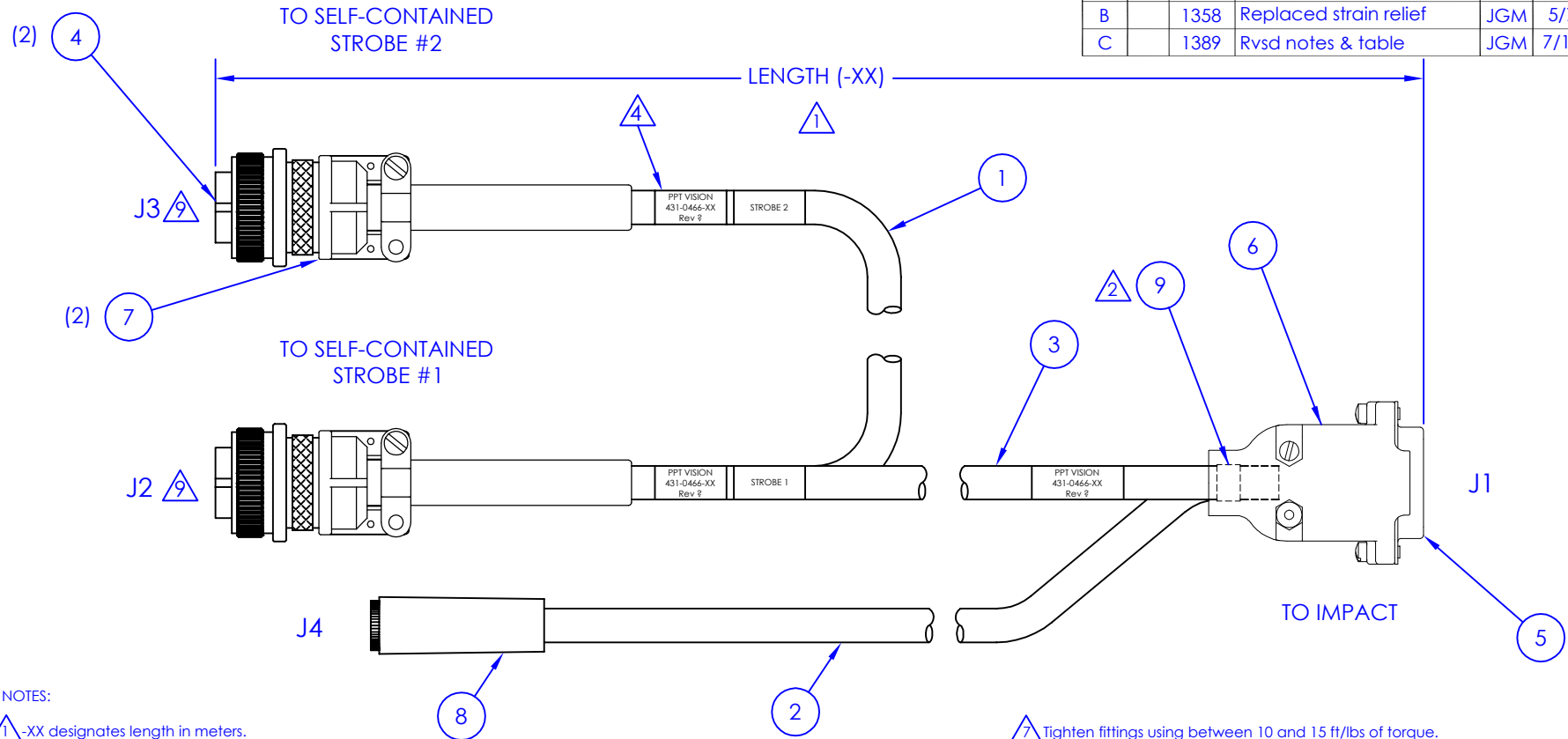

NOTES:

- ① -XX designates length in meters.
- ② Install ferrule on the outer jacket of both cables and fold the braided shield over the ferrule. Ferrule must be positioned in backshell strain relief area. See Detail A on sheet 2.
- ③ Bend tabs over cable jacket.
- ④ Add a label with "PPT Vision", the cable part number, and rev level to each end of the cable. Label J2 end "Strobe 1" and J3 end "Strobe 2".
- ⑤ Splice the white wires and black wires of cables (items 2 & 3) in the backshell of J1. Solder and shrink tube each connection.
- ⑥ Splice the red wires and green wires of cables (items 1 & 3) in the backshell of J2. Solder and shrink tube each connection.

- ⑦ Tighten fittings using between 10 and 15 ft/lbs of torque.
- ⑧ Do not cut jacket insulation back past strain relief.
- ⑨ Attach shield to connector shell. See sheet 3.
- ⑩ Apply shrink tubing over all connections.

Tolerances		PPT VISION		12988 Valley View Road Eden Prairie, MN 55344	
.x	±.015	Cable Assy, Dual Strb Trig, Impact to 2 Self-cont Lights w/Var PW			
.XX	±.010				
.XXX	±.005				
All angles ±2°					
Break all sharp corners unless noted					
DRAWN	J. Manias	B	431-0466-XX	REV	C
DATE	3 Apr 02	SCALE 1:1		SHEET 1 of 3	

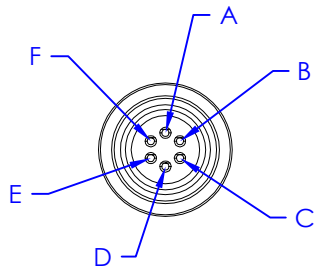

J2 & J3 (SOLDER SIDE)

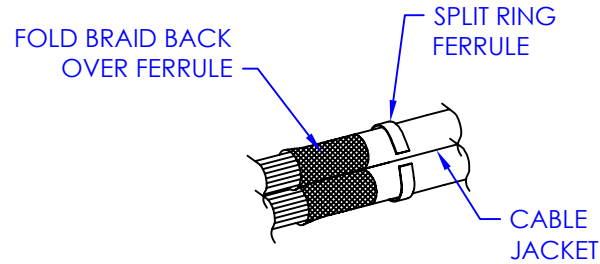

△ DETAIL A

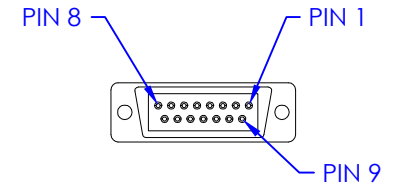

J1 (SOLDER SIDE)

Connector J1 (Item 5) Backshell (Item 6) Ferrule (Item 9)	Connector J2 (Item 4) Backshell (Item 7) "Strobe 1"	Connector J3 (Item 4) Backshell (Item 7) "Strobe 2"	Connector J4 (Item 8)	△△ Cable (item 3) Wire Color	△ Cable (item 1) Wire Color	△ Cable (item 2) Wire Color	Signal Name
1	E			Orange			Strobe 1+
9	D			Blue			Strobe 1-
10		D		Green	Green		Strobe 2-
2		E		Red	Red		Strobe 2+
	A (2 wires)	A	Center Tab	White	White	White	12 VDC
	B (2 wires)	B	Outer Tab	Black	Black	Black	Common
Ferrule	F	F		Shield	Shield		Shield

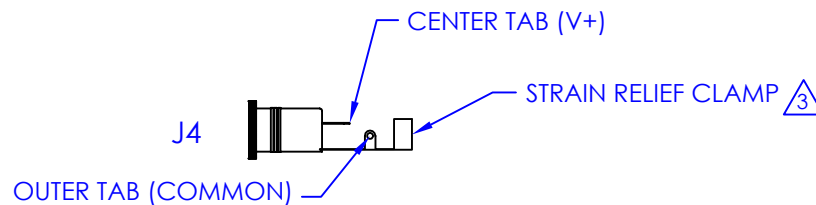

Tolerances .x .xx .xxx All angles ±2° Break all sharp corners unless noted	PPT VISION 12988 Valley View Road Eden Prairie, MN 55344	
	Cable Assy, Dual Strb Trig, Impact to 2 Self-cont Lights w/Var PW	
DRAWN J. Manias	B	431-0466-XX
DATE 3 Apr 02	SCALE 1:1	SHEET 2 of 3

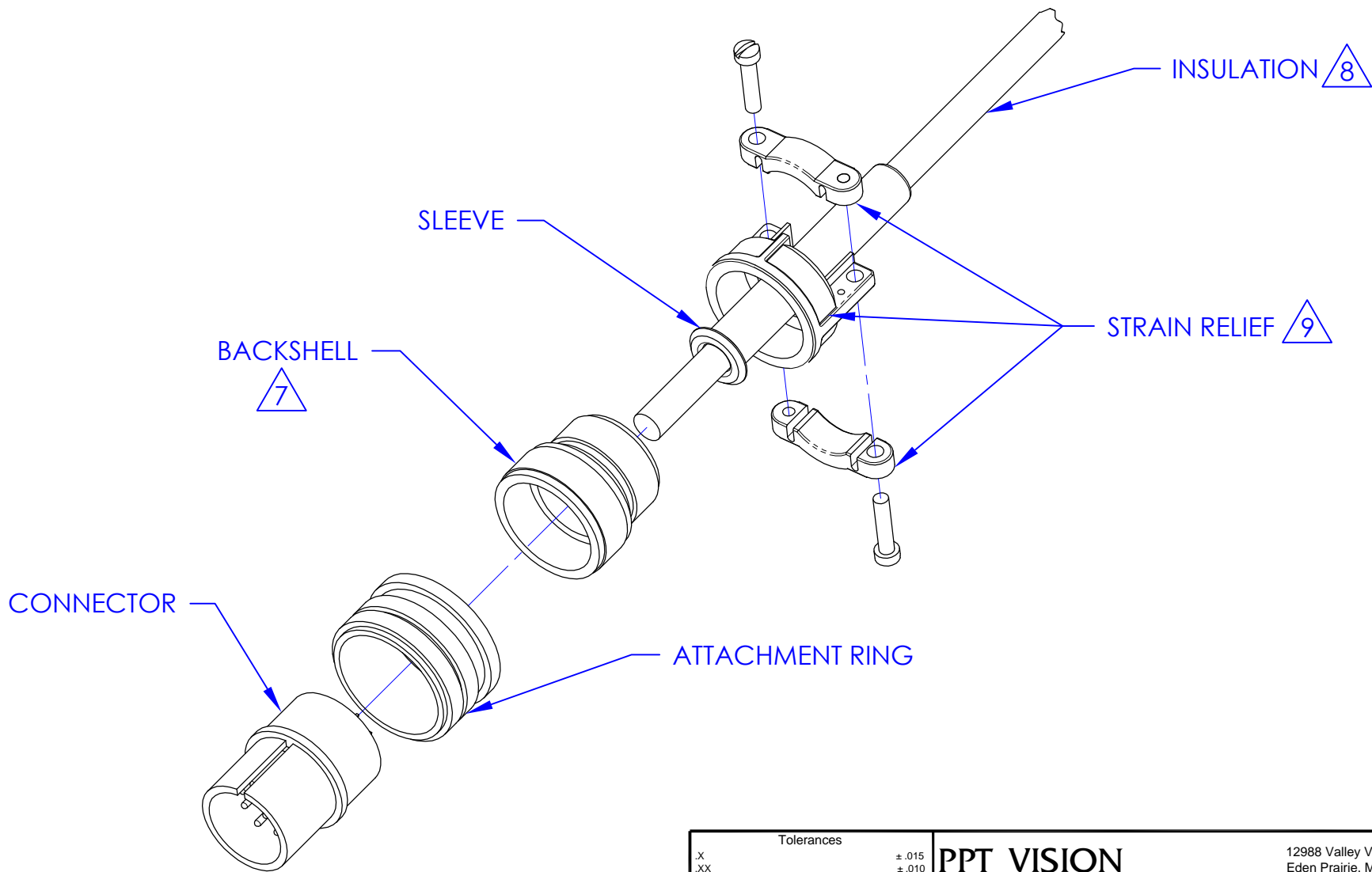

Tolerances .X ±.015 .XX ±.010 .XXX ±.005		PPT VISION 12988 Valley View Road Eden Prairie, MN 55344	
All angles ±2° Break all sharp corners unless noted		Cable Assy, Dual Strb Trig, Impact to 2 Self-cont Lights w/Var PW	
DRAWN J. Manias	A	431-0466-XX	REV C
DATE 7 May 03	SCALE 3:4	SHEET 3 of 3	